

**OREGON INVENTORY OF HISTORIC PROPERTIES
HISTORIC RESOURCE SURVEY FORM**

Note: For properties 35 years old and newer, starred (*) sections are the only required fields.

*County: **Benton**

*Street Address: 22930 HARRIS RD				*City: Philomath			
USGS Quad Name:			UTM (NAD83) Zone: 10		Northing:		Easting:
Township: 11S	Range: 06W	Section: 30	Block:	Lot: 1	Map: 1163000	Tax Lot #: 01000	
Historic Name: Charles King House					Grouping or Cluster Name:		
*Date of Construction: c. 1870		Other Name: Morgan House					
Historic Use or Function: Single-family residence			*Current Use: Single-family residence			Associated Archaeological Site: Unknown	

Architectural Classification(s): Gothic Vernacular		Plan Type/Shape: T-shaped		Number of Stories: 2	
Foundation Material: Rocks		Structural Framing: Wood		Moved? Unknown	
Roof Type/Material: Intersecting gable / Composition shingle		Window Type/Material: 4/4 double-hung sash			
Exterior Surface Materials Primary: Drop		Secondary:		Decorative:	

Exterior Alterations or Additions/Approximate Date: **Original porch extended entire width of main façade.**

Number and type of associated resources: **Privy (1)**

Integrity:	Condition: Fair	Local Ranking: 3C	National Register Listed? Unknown
------------	------------------------	--------------------------	--

Preliminary National Register Findings:	Potentially Eligible:	<input type="checkbox"/> Individually	or	<input type="checkbox"/> As a contributing resource in a district
	Not Eligible:	<input type="checkbox"/> Intact but lacks distinction		
		<input type="checkbox"/> Altered (choose one):	<input type="checkbox"/> Reversible/Potentially eligible individually or in district	
		<input type="checkbox"/> Not 50 years old	<input type="checkbox"/> Reversible/Ineligible as it lacks distinction	
		<input type="checkbox"/> Irretrievable loss of integrity		

Description of Physical and Landscape Features:

Two entry doors on the main façade; interior is intact with original doors, hardware, wainscoting, etc. Overhanging eaves; Cornice-style window heads. Cornerboards topped by simple capitals; rake and frieze boards.

The Charles King house is located in the former Harris community. Situated on a terrace of the Mary's River, the house fronts east facing Harris Road. Railroad tracks are located to the south of the house. Owned by Southern Pacific today, these tracks were originally the route the Corvallis to Yaquina Bay Railroad completed in 1885. The Harris covered bridge, spanning the Mary's River, is located directly to the north of the house.

There is an old apple orchard to the west of the house. Large oaks and a big leaf maple are located in front of the house.

A barn-like shed is attached to the rear of the house. The privy, located to the north of the house, is currently being used.

Statement of Significance [Required ONLY for Intensive Level Surveys] (use additional sheets if necessary)

SEE CONTINUATION SHEET

*Researcher/Organization: Mary Weber & Kathy Schutt / BCHM	*Date Recorded: 11/7/1984
---	----------------------------------

Survey Form (Page 1 of 3)	Local Designation # 206A	SHPO #
---------------------------	---------------------------------	--------

OREGON INVENTORY OF HISTORIC PROPERTIES
HISTORIC RESOURCE SURVEY FORM

Continuation Sheet

*County: Benton

*Street Address: 22930 HARRIS RD	*City: Philomath
---	-------------------------

Statement of Significance:

Written by Mary Weber & Kathy Schutt in 11/7/1984:

The Charles King House, probably built sometime in the 1870's, is a very intact example of an 1870's vernacular farmhouse. Notable features include the two entry doors on the main façade. The house is associated with Charles King, a member of the King Family of King's Valley. The house is also associated with the construction of the Corvallis to Yaquina Bay railroad. The rear addition of the house was built to board railroad workers. Later, in the early 20th Century, the house was associated with the town of Harris and the logging industry. Workers at the large mill at Harris boarded here.

The house is located on a portion of the original George Mason Donation Land Claim secured in 1855. In 1866, George Mason sold this land to his former son-in-law, John Aiken. By this time John Aiken's first wife, Catherine Mason had died. John Aiken remarried Harriet Hurlbert in 1862. Charles King purchased this property in 1869. Supposedly, the front portion of this house was already there when King purchased the land. Architectural detail suggests an 1870's house instead.

Charles King was the son of Stephen and Anna Maria King. Stephen King's Donation Land Claim was located just to the west of the Aiken property. When Stephen King died, Charles inherited his property. Charles married Susan Robinette in 1869, the same year he purchased this land from Aiken.

Charles King served on the school board and ran the store and post office at Elam (the first name for Harris). When the Corvallis to Yaquina railroad was under construction, Charles King added the rear wing to his house and he and his second wife, Margaret (Barnes) King furnished room and board for the workers. Charles King died in 1915. Margaret and her daughter Ethel Morgan continued to operate a boarding house for sawmill workers and loggers. They also ran the post office. The Morgan family owned the house until Ethel's death in 1977.

*Researcher/Organization: Mary Weber & Kathy Schutt / BCHM		*Date Recorded: 11/7/1984	
Continuation Page		Local Designation # 206A	SHPO #

OREGON INVENTORY OF HISTORIC PROPERTIES
HISTORIC RESOURCE SURVEY FORM

Continuation Sheet

*County:

Benton

*Street Address: 22930 HARRIS RD

*City: Philomath

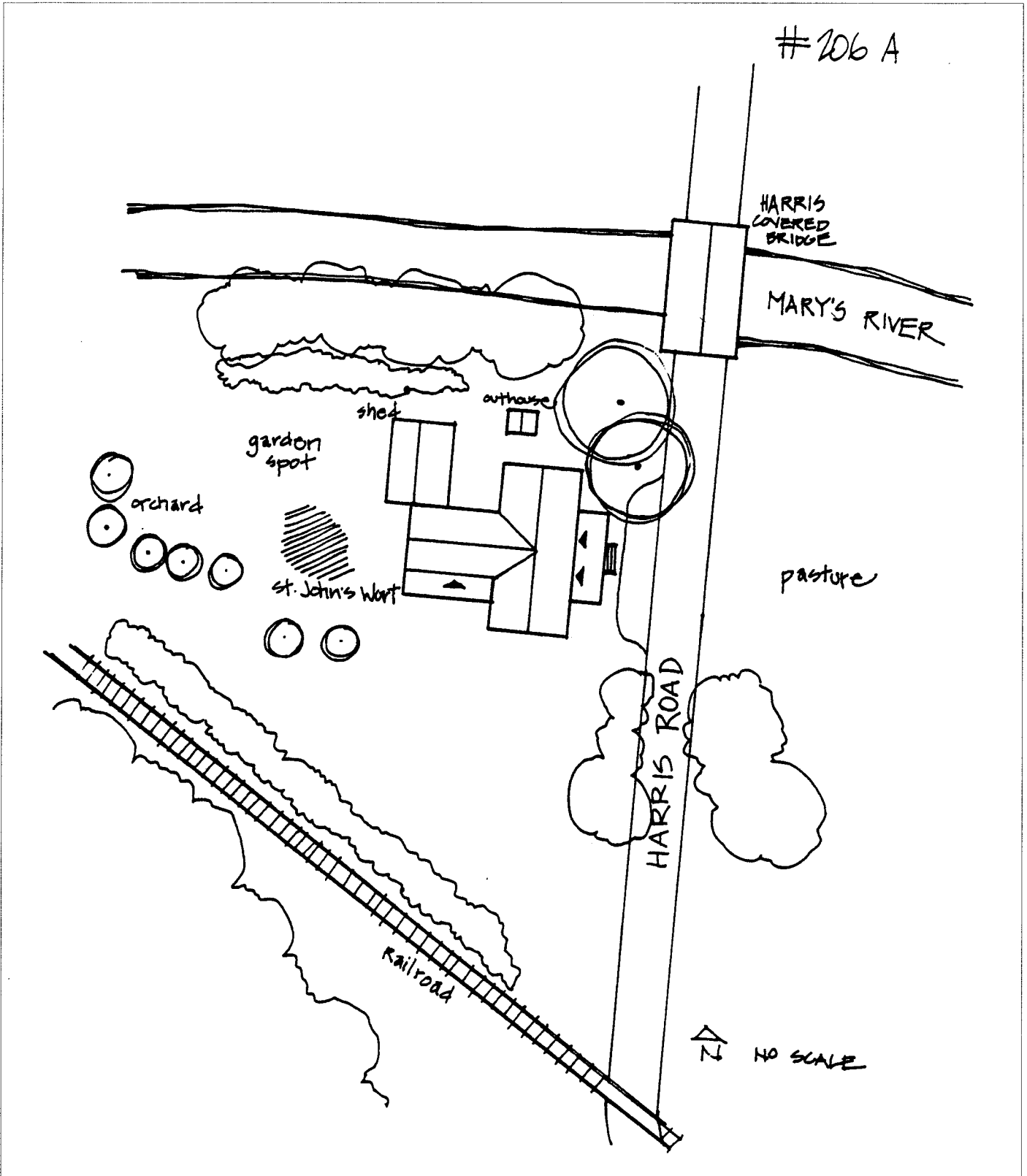

*Researcher/Organization: Mary Weber & Kathy Schutt / BCHM

*Date Recorded: 11/7/1984

Continuation Page

Local Designation # 206A

SHPO #

**OREGON INVENTORY OF HISTORIC PROPERTIES
HISTORIC RESOURCE SURVEY FORM**

Note: This page of the survey form is required ONLY for Intensive Level Survey

*County: **Benton**

*Street Address: **22930 HARRIS RD** *City: **Philomath**

Architect and/or Builder:	Owner Type: <input checked="" type="checkbox"/> Private <input type="checkbox"/> Local <input type="checkbox"/> State <input type="checkbox"/> Federal <input type="checkbox"/> Mixed
Addition or Subdivision Name:	Owner Info: MCKEE AARON & KRISTEN
Area(s) of Significance: 19th Century Architecture	22930 HARRIS RD
Property Category: <input checked="" type="checkbox"/> Building <input type="checkbox"/> Structure <input type="checkbox"/> Site <input type="checkbox"/> Object <input type="checkbox"/> District	PHILOMATH OR 97370

Documentation

Research Sources: <input checked="" type="checkbox"/> Title/Deed Records <input type="checkbox"/> Sanborn Maps <input type="checkbox"/> Obituary Index <input type="checkbox"/> City Directories <input checked="" type="checkbox"/> Census Records <input type="checkbox"/> Biographical Encyclopedias <input type="checkbox"/> Newspapers	<input type="checkbox"/> Building Permits <input type="checkbox"/> Tax Records <input type="checkbox"/> SHPO Files <input type="checkbox"/> State Archives <input type="checkbox"/> State Library <input checked="" type="checkbox"/> Local Histories <input checked="" type="checkbox"/> Personal Interviews <input type="checkbox"/> Historic Photographs	Local Library (specify): University Library (specify): Historical Society (specify): Other (specify): Benton County Historical Museum
---	--	--

Bibliographic References (books, articles, interviews, etc.):

Benton County Deed Registry.

Brown, Dorothy, "Back When in Benton County," Benton Bulletin, Philomath, Oregon, Nov. 26, 1980.

Browning, Elsie Bennett, "Benton County Marriages 1851-1922," E.L.S. Brown, Salem, Oregon, 1981.

Census Records, 1860.

Genealogical Forum of Portland, Oregon, "Genealogical Material in Oregon Donation Land Claims," Portland, Oregon, 1957.

Irvine, Mrs. William, "Index to Donation Land Claim Records," Genealogical Forum of Portland, Oregon, N.D.

Morgan, Dave, "Back When in Benton County," Benton Bulletin, Dec. 17, 1980.

Morgan, Dave. Personal Communication, 1984.

*Researcher/Organization: **Mary Weber & Kathy Schutt / BCHM** *Date Recorded: **11/7/1984**

Survey Form (Page 3 of 3) Local Designation # **206A** SHPO #