

**OREGON INVENTORY OF HISTORIC PROPERTIES
HISTORIC RESOURCE SURVEY FORM**

Note: For properties 35 years old and newer, starred (*) sections are the only required fields.

*County: **Benton**

*Street Address: 26861 DAWSON RD				*City: Monroe	
USGS Quad Name:			UTM (NAD83) Zone: 10		Northing: Easting:
Township: 14S	Range: 05W	Section: 09	Block:	Lot:	Map: 1450900 Tax Lot #: 00800
Historic Name: Albert Zierolf Farm Group				Grouping or Cluster Name:	
*Date of Construction: c. 1899		Other Name: Judd Zierolf Farm Group			
Historic Use or Function: Barn/Farm building			*Current Use: Barn/Farm building		Associated Archaeological Site: Unknown

Architectural Classification(s): Queen Anne / Vernacular	Plan Type/Shape: T-shaped	Number of Stories: 2
Foundation Material: Concrete block	Structural Framing:	Moved? No
Roof Type/Material: Gable / Unknown	Window Type/Material: 1/1 double-hung wood	
Exterior Surface Materials Primary: Drop	Secondary: Wood shingle	Decorative:

Exterior Alterations or Additions/Approximate Date: **Barn foundation altered and interior stalls removed.**

Number and type of associated resources: **Woodshed (c.1899), garage (c.1910-20), machine shed (3)**

Integrity:	Condition: Good	Local Ranking: 3C	National Register Listed? Unknown
------------	------------------------	--------------------------	--

Preliminary National Register Findings:

Potentially Eligible:	<input type="checkbox"/> Individually	or	<input type="checkbox"/> As a contributing resource in a district
Not Eligible:	<input type="checkbox"/> Intact but lacks distinction		
	<input type="checkbox"/> Altered (choose one):	<input type="checkbox"/> Reversible/Potentially eligible individually or in district	
		<input type="checkbox"/> Reversible/Ineligible as it lacks distinction	
	<input type="checkbox"/> Not 50 years old	<input type="checkbox"/> Irretrievable loss of integrity	

Description of Physical and Landscape Features:
SEE CONTINUATION SHEET

Statement of Significance [Required ONLY for Intensive Level Surveys] (use additional sheets if necessary)
SEE CONTINUATION SHEET

*Researcher/Organization: Mary Weber & Kathy Schutt / BCHM	*Date Recorded: 12/20/1984
Survey Form (Page 1 of 3)	Local Designation # 394 SHPO #

OREGON INVENTORY OF HISTORIC PROPERTIES
HISTORIC RESOURCE SURVEY FORM

Continuation Sheet

*County: Benton

*Street Address: 26861 DAWSON RD	*City: Monroe
---	----------------------

Physical and Landscape Features:

House:

Wrap around veranda on the main façade features turned porch posts, decoratively sawn brackets, spindle frieze, and turned balusters. Some stick work on house, two gablets on porch's hip roof. House has one story wing at rear. Medium-pitched intersecting gable roof has overhanging eaves. Stick work on house serves as window heads. Windows are often grouped two to a bay. Main façade has one story slant bay. The wall construction and structural framing are of wood. Exterior walls are covered with wide horizontal drop siding with decorative wood shingles in the gable ends. cornerboards, rake and frieze boards act as trim.

Barn: (SEE FORM #394A)

Rectangular plan with openings on gable end. Drive through center with stalls on either side. Very large, high loft area. One story, with loft. Sits on concrete footings. Has a gable roof with overhanging eaves, clad with metal. Siding is vertical board and batten. Framing is of rough sawn lumber with mortise and tenon joints. The roof is double framed. The barn has fixed sash windows, each with nine lights. There are two windows on each side of the barn. It has a decoratively sawn hay hood, cornerboards with simple capitals, a louvered cupola with cross gable roof and finial, and rolling door hardware.

Woodshed: (SEE FORM #394B)

Square nails indicate that the woodshed may be contemporary with the house. It is rectangular, one-and-a-half stories high, and has a gable roof. It has horizontal drop siding of wood with cornerboards and rake and frieze boards. A rolling door is located on the north elevation.

Garage:

The garage has a gable roof with overhanging eaves, exposed rafters and knee braces at the gable ends. The entry is composed of sliding doors on the north elevation. It has horizontal drop siding of wood with cornerboards.

The Zierolf Farm is located on Dawson Road approximately one-third of a mile west of the Highway 99 intersection. The house is accessed by a long drive located at the first ninety degree turn in Dawson Road. The house, situated in alluvial lowlands of the Willamette Valley, fronts east. The tracks of the Corvallis and Alsea railroad (later purchased by the Portland, Eugene, Eastern and Southern Pacific) are located approximately two-tenths of a mile east of the farm. The former station of Burnett was located at the intersection of the tracks and Dawson Road.

Statement of Significance:

Written by Mary Weber & Kathy Schutt in 12/20/1984:

The Albert Zierolf House, with its design, setting, location, and materials intact, is architecturally significant as an example of a rural turn of the century farm house employing elements of the Queen Anne, Stick and Eastlake styles. The significance of the property is enhanced by the survival of a horse barn built by Canadian carpenter, Earnest Brimner. Like the house, the barn is remarkable for its integrity. Brimner barns, of which many were built in the Monroe area between 1897 and 1918, have a characteristic form and specific architectural elements that give them a marked identity in southeast Benton County.

Albert Zierolf was the son of Casper and Mary Zierolf. Casper and Mary Zierolf emigrated to Oregon, from Ohio, in 1870. In 1871, the Zierolfs purchased the current property and devoted themselves to farming and stock-raising. Their son, Albert, born in 1869, received title to a portion of Casper's property in 1899. Presumably, it was Albert who had the current house and barn built at that time. In this house he lived with several of his siblings since he never married. Albert Zierolf operated a large threshing crew. Grain grown in the area in the early 20th Century was transported to the Wilhelm Mill in Monroe. Albert Zierolf died in 1927. The property eventually passed to Albert's younger brother, Judd Zierolf. Judd Zierolf passed away in 1942.

*Researcher/Organization: Mary Weber & Kathy Schutt / BCHM	*Date Recorded: 12/20/1984
---	-----------------------------------

Continuation Page	Local Designation # 394	SHPO #
-------------------	--------------------------------	--------

OREGON INVENTORY OF HISTORIC PROPERTIES
HISTORIC RESOURCE SURVEY FORM

Continuation Sheet

*County: **Benton**

*Street Address: **26861 DAWSON RD**

*City: **Monroe**

394A
394B

FIELD

view to hills 

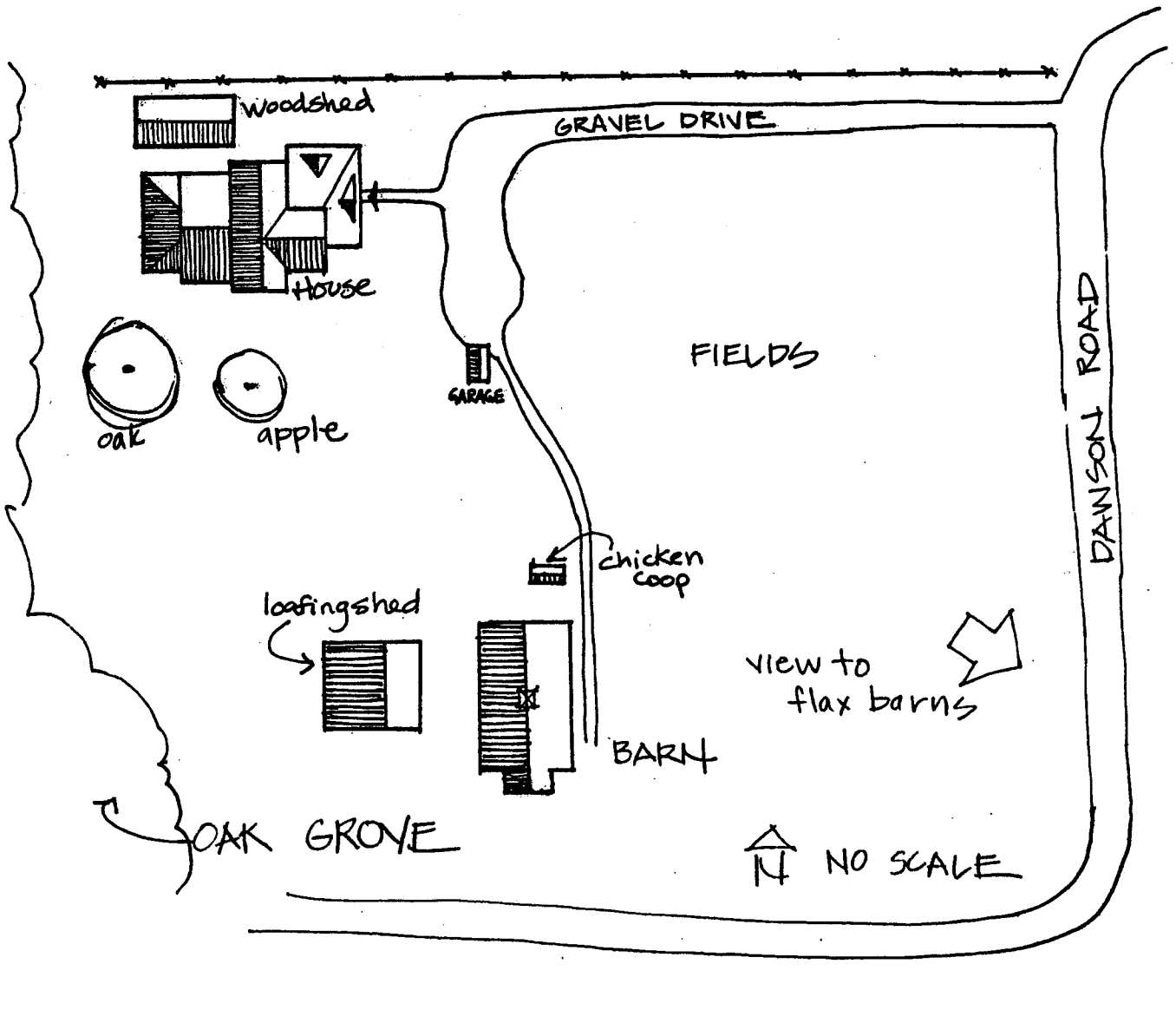

*Researcher/Organization: **Mary Weber & Kathy Schutt / BCHM**

*Date Recorded: **12/20/1984**

Continuation Page

Local Designation # **394**

SHPO #

**OREGON INVENTORY OF HISTORIC PROPERTIES
HISTORIC RESOURCE SURVEY FORM**

Note: This page of the survey form is required ONLY for Intensive Level Survey

*County: **Benton**

*Street Address: 26861 DAWSON RD		*City: Monroe	
Architect and/or Builder:		Owner Type:	
Addition or Subdivision Name:		<input checked="" type="checkbox"/> Private <input type="checkbox"/> Local <input type="checkbox"/> State <input type="checkbox"/> Federal <input type="checkbox"/> Mixed	
Area(s) of Significance: 19th Century Architecture		Owner Info: GORACKE PEGGY MARIE	
Property Category:		26861 DAWSON RD	
<input checked="" type="checkbox"/> Building <input type="checkbox"/> Structure <input type="checkbox"/> Site <input type="checkbox"/> Object <input type="checkbox"/> District		MONROE OR 97456-9731	

Documentation		
Research Sources: <input checked="" type="checkbox"/> Title/Deed Records <input type="checkbox"/> Sanborn Maps <input type="checkbox"/> Obituary Index <input type="checkbox"/> City Directories <input checked="" type="checkbox"/> Census Records <input checked="" type="checkbox"/> Biographical Encyclopedias <input type="checkbox"/> Newspapers	<input type="checkbox"/> Building Permits <input type="checkbox"/> Tax Records <input type="checkbox"/> SHPO Files <input type="checkbox"/> State Archives <input type="checkbox"/> State Library <input checked="" type="checkbox"/> Local Histories <input checked="" type="checkbox"/> Personal Interviews <input type="checkbox"/> Historic Photographs	Local Library (specify): University Library (specify): Historical Society (specify): Other (specify): Benton County Historical Museum

Bibliographic References (books, articles, interviews, etc.):

Anon., "Portrait and Biographical Record of the Willamette Valley, Oregon." Chapman Publishing Co., Chicago, 1903.

Benton County Deed Registry

Daughters of the American Revolution, Cemetery Records of Benton County Oregon, Winema Chapter of the DAR, Corvallis, Oregon, 1948.

Miller, Norman, Personal Communication, 1985.

Sekora, Lynda, "Architectural Criteria for Identifying Brimner Barns," Manuscript submitted to the Benton County Historical Museum, 1984.

United States Census Records, 1900.

*Researcher/Organization: Mary Weber & Kathy Schutt / BCHM		*Date Recorded: 12/20/1984	
Survey Form (Page 3 of 3)		Local Designation # 394	SHPO #