

OREGON INVENTORY OF HISTORIC PROPERTIES
HISTORIC RESOURCE SURVEY FORM

Continuation Sheet

*County: **Benton**

*Street Address: **26208 FINLEY REFUGE RD**

*City:

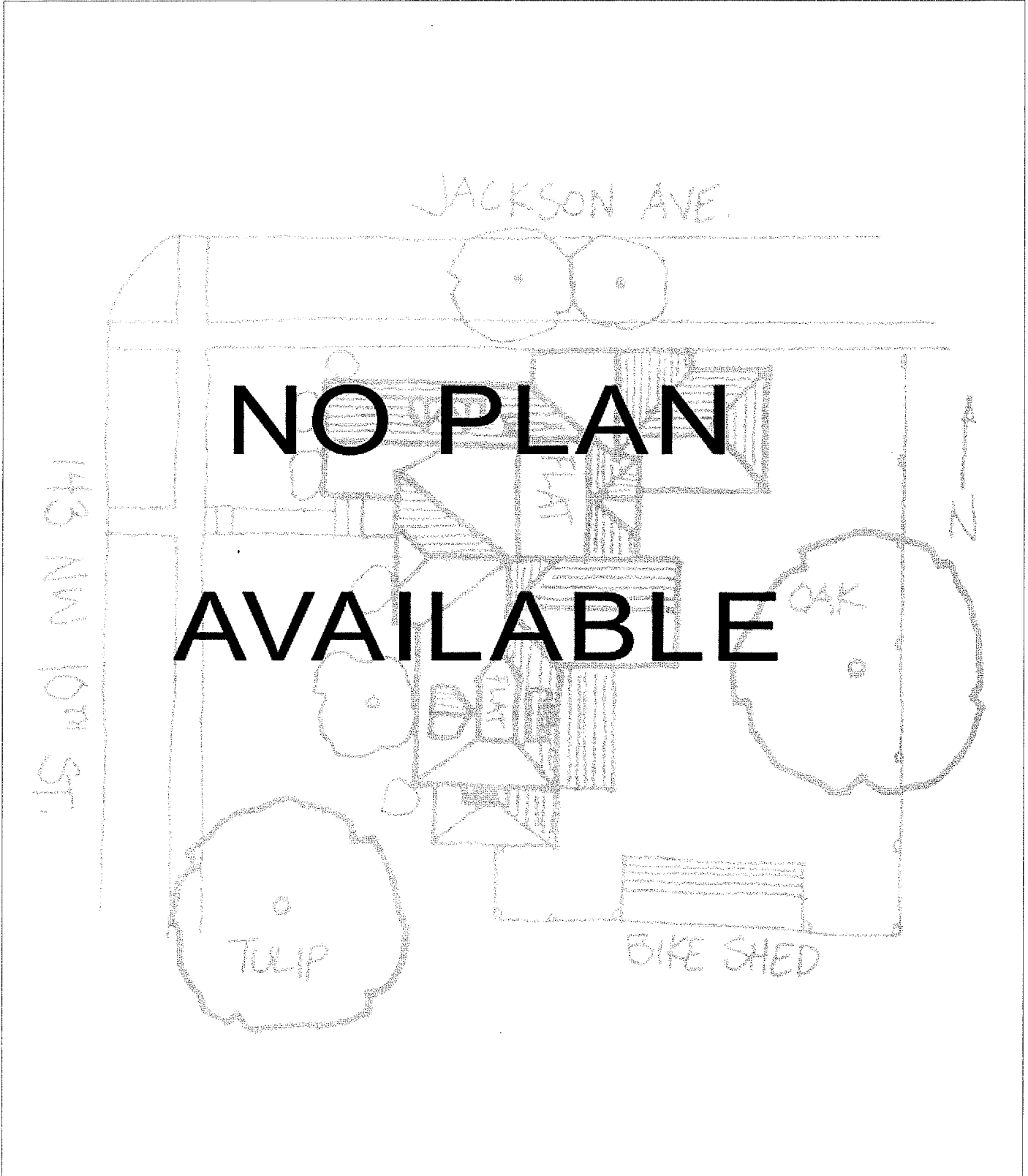

*Researcher/Organization: **Mary Weber & Kathy Schutt / BCHM**

*Date Recorded:

Continuation Page

Local Designation # **999E**

SHPO #

