

| ID | PROJECT LOCATION |
|----|--|
| K1 | INDEPENDENCE HWY/SPRINGHILL DR—RECONFIGURE INTERSECTION, CHANNELIZE, GUIDE SIGNING |
| K6 | PALESTINE AVE/OAK GROVE DR—PERFORM MINOR RE—CHANNELIZATION AND REALIGNMENT TO FAVOR PALESTINE—WEST TO OAKGROVE DR—SOUTH MOVEMENT |
| K5 | INDEPENDENCE HWY/RVALS AVE—INSTALL ADVANCE BEACON, SIGNAGE, AND STRIPING TO DESIGNATE POOR SIGHT DISTANCE INTERSECTION |
| A6 | GIBSON HILL DR/SCENIC DR/OAKGROVE DR—REALIGN INTERSECTION |
| A5 | US 20/SCENIC DRIVE—CONSTRUCT TURN LANES |
| G6 | SUMMIT HWY/US 20—PROVIDE EASTBOUND TURN LANE AND CHANNELIZE SIDE STREET MOVEMENTS |
| K4 | PRIEST RD/US 20—RESTRIPE AND SIGN PRIEST RD APPROACH |
| K3 | WREN RD/HWY 223—REALIGN NORHTBOUND RIGHT TURN LANE, NEW SIGNING, CHANNELIZATION |
| G5 | HWY 223/US 20—PROVIDE EASTBOUND TURN LANE AND CHANNELIZE SIDE STREET MOVEMENTS |
| G1 | WEST HILLS RD/RESERVOIR RD—INSTALL TRAFFIC SIGNAL |
| G2 | WEST HILLS RD/53rd ST—INSTALL TRAFFIC SIGNAL |
| K7 | US 20/MARYS RIVER ESTATES—CONSTRUCT RIGHT TURN DECELERATION LANE |
| K2 | GRANGE HALL RD/FERN RD—INSTALL ADVANCE BEACON, SIGNAGE, AND STRIPING TO DESIGNATE POOR SIGHT DISTANCE INTERSECTION |
| F6 | AIRPORT RD/BELLFOUNTAIN RD—GRADE TO IMPROVE SIGHT DISTANCES AT INTERSECTION |
| F4 | GREENBERRY RD/BELLFOUNTAIN RD—REALIGN GREENBERRY RD 150 FEET TO SOUTH, PROVIDE SOUTHBOUND LEFT—TURN POCKET ON BELLFOUNTAIN SOUTH OF THE BRIDGE |
| K8 | FISH HATCHERY RD/HWY 34—CONSTRUCT TURN LANES |
| K9 | HWY 34 IN ALSEA REGION—REALIGN CURVES |
| G7 | OLD RIVER RD/HWY 99W—CONSTRUCT TURN LANES |

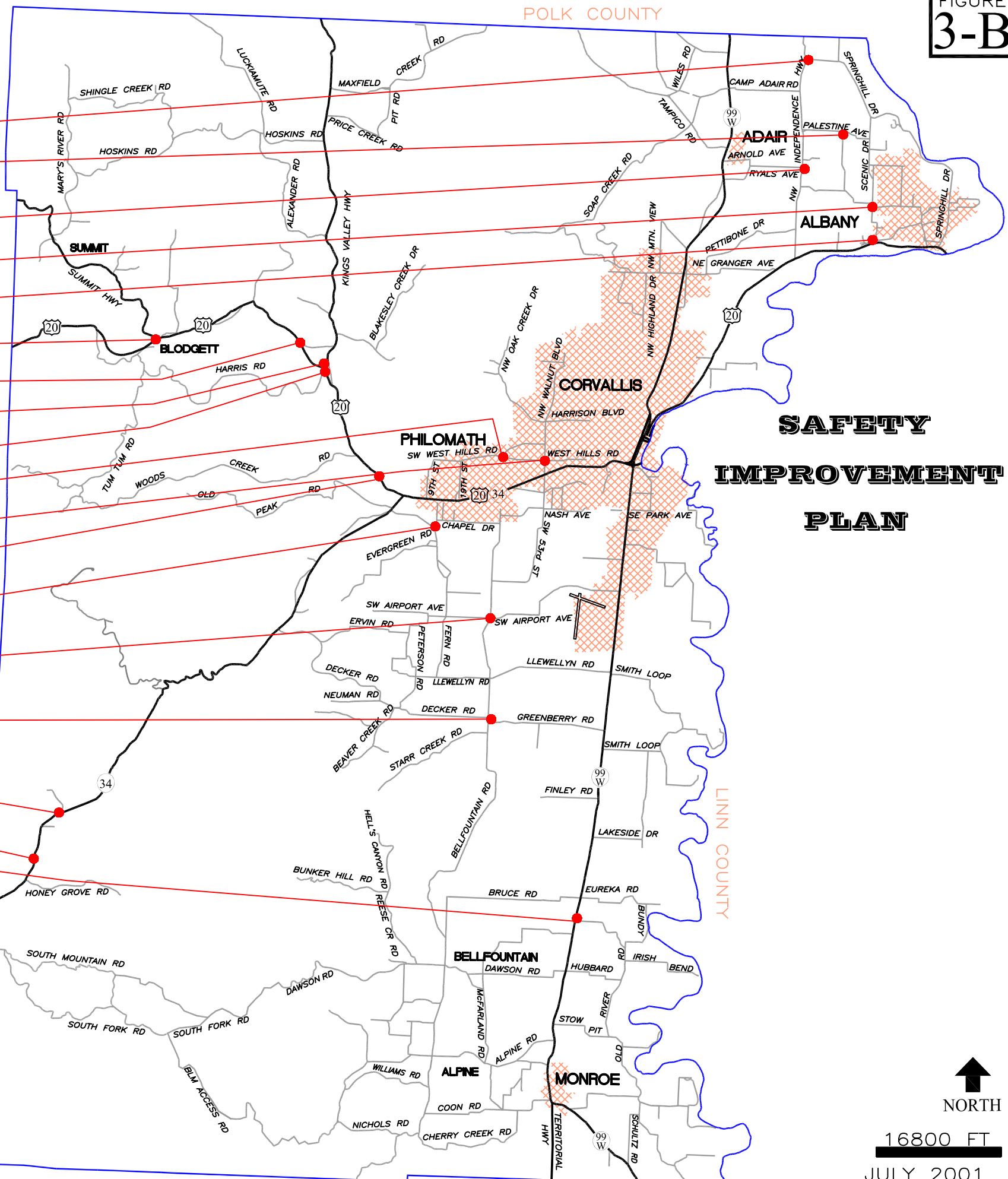

TRANSPORTATION SYSTEM PLAN



NORTH

16800 FT

JULY 2001