

ID	PROJECT LOCATION
A4	INDEPENDENCE HIGHWAY/ US 20 INSTALL TRAFFIC SIGNAL
C3	RESERVOIR ROAD/SW 53rd ST RAILROAD CROSSING
H6	VAN BUREN ST BRIDGE NEW BRIDGE— CORVALLIS TSP/ODOT
F3	US 20/HWY 34/ HWY 99W BUILD EAST TO SOUTH RAMP
C2	US 20/HWY 34 INSTALL TRAFFIC SIGNAL AT JUNCTION
F7	HWY 99W: RIVERGREEN AVE TO AIRPORT AVE WIDEN THIS SECTION OF HGHWAY
I1	AIRPORT AVE IMPROVE TO CITY ARTERIAL STANDARD
O2	GRAVEL ROAD SURFACING PROGRAM

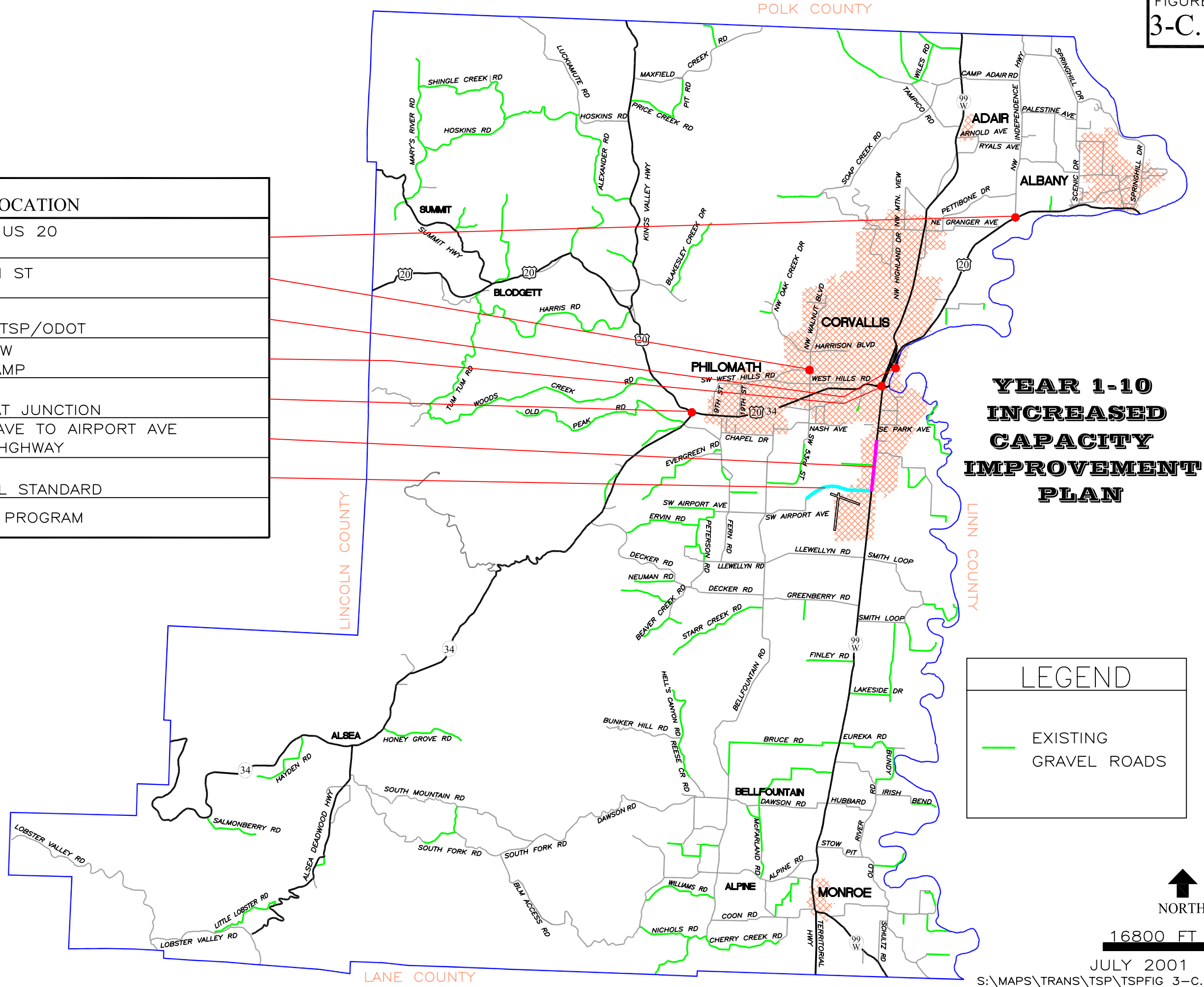

**YEAR 1-10  
INCREASED  
CAPACITY  
IMPROVEMENT  
PLAN**

LEGEND

— EXISTING  
GRAVEL ROADS



16800 FT

JULY 2001