

ID	PROJECT LOCATION
K1	INDEPENDENCE HWY/SPRINGHILL DR—RECONFIGURE INTERSECTION, CHANNELIZE, GUIDE SIGNING
K6	PALESTINE AVE/OAK GROVE DR—PERFORM MINOR RE—CHANNELIZATION AND REALIGNMENT TO FAVOR PALESTINE—WEST TO OAKGROVE DR—SOUTH MOVEMENT
K5	INDEPENDENCE HWY/RVYALS AVE—INSTALL ADVANCE BEACON, SIGNAGE, AND STRIPING TO DESIGNATE POOR SIGHT DISTANCE INTERSECTION
A6	GIBSON HILL DR/SCENIC DR/OAKGROVE DR—REALIGN INTERSECTION
A5	US 20/SCENIC DRIVE—CONSTRUCT TURN LANES
G6	SUMMIT HWY/US 20—PROVIDE EASTBOUND TURN LANE AND CHANNELIZE SIDE STREET MOVEMENTS
K4	PRIEST RD/US 20—RESTRIPE AND SIGN PRIEST RD APPROACH
K3	WREN RD/HWY 223—REALIGN NORHTBOUND RIGHT TURN LANE, NEW SIGNING, CHANNELIZATION
G5	HWY 223/US 20—PROVIDE EASTBOUND TURN LANE AND CHANNELIZE SIDE STREET MOVEMENTS
G1	WEST HILLS RD/RESERVOIR RD—INSTALL TRAFFIC SIGNAL
G2	WEST HILLS RD/53rd ST—INSTALL TRAFFIC SIGNAL
K7	US 20/MARYS RIVER ESTATES—CONSTRUCT RIGHT TURN DECELERATION LANE
K2	GRANGE HALL RD/FERN RD—INSTALL ADVANCE BEACON, SIGNAGE, AND STRIPING TO DESIGNATE POOR SIGHT DISTANCE INTERSECTION
F6	AIRPORT RD/BELLFOUNTAIN RD—GRADE TO IMPROVE SIGHT DISTANCES AT INTERSECTION
F4	GREENBERRY RD/BELLFOUNTAIN RD—REALIGN GREENBERRY RD 150 FEET TO SOUTH, PROVIDE SOUTHBOUND LEFT—TURN POCKET ON BELLFOUNTAIN SOUTH OF THE BRIDGE
K8	FISH HATCHERY RD/HWY 34—CONSTRUCT TURN LANES
K9	HWY 34 IN ALSEA REGION—REALIGN CURVES
G7	OLD RIVER RD/HWY 99W—CONSTRUCT TURN LANES

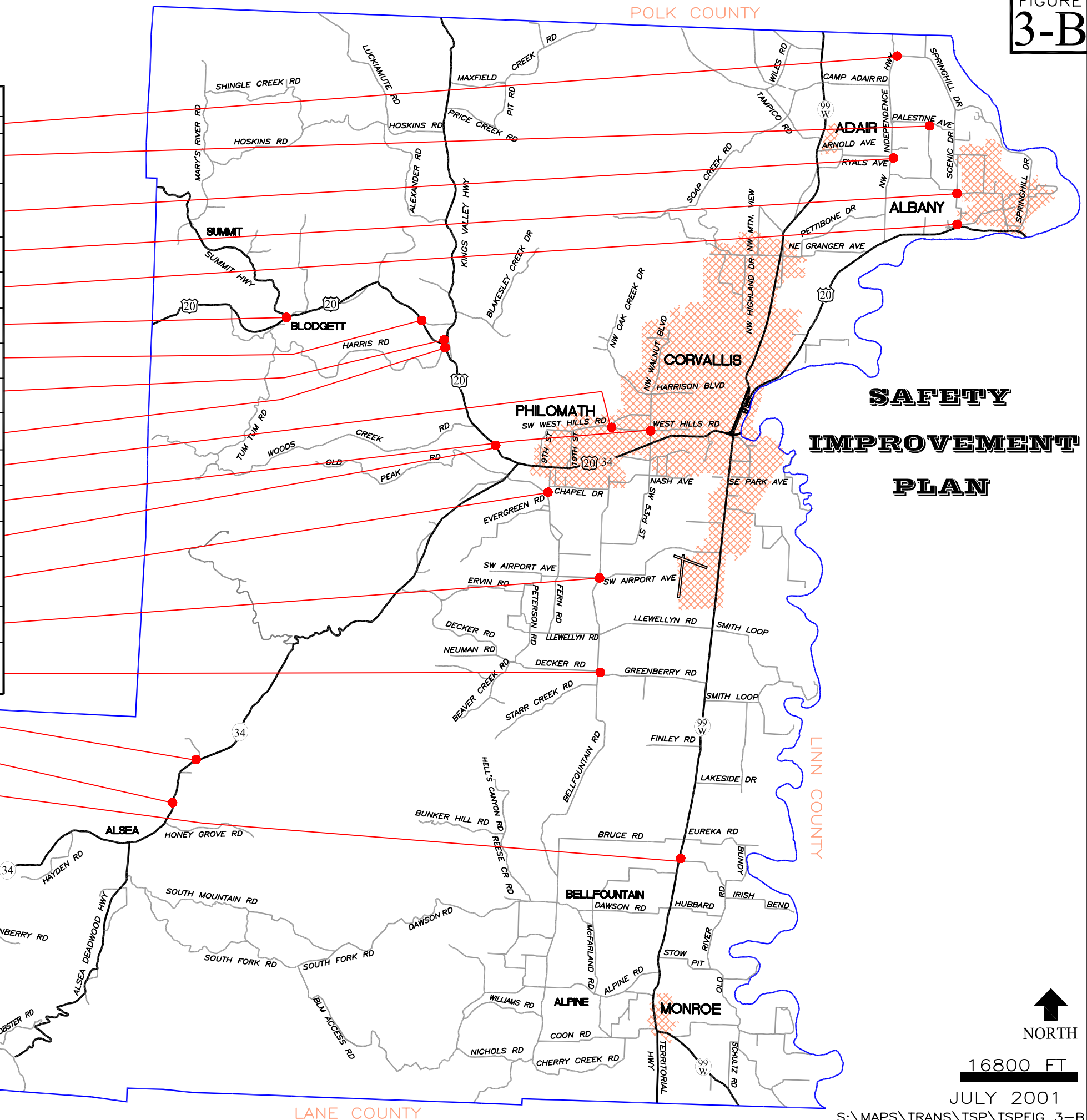

**SAFETY  
IMPROVEMENT  
PLAN**



16800 FT

JULY 2001