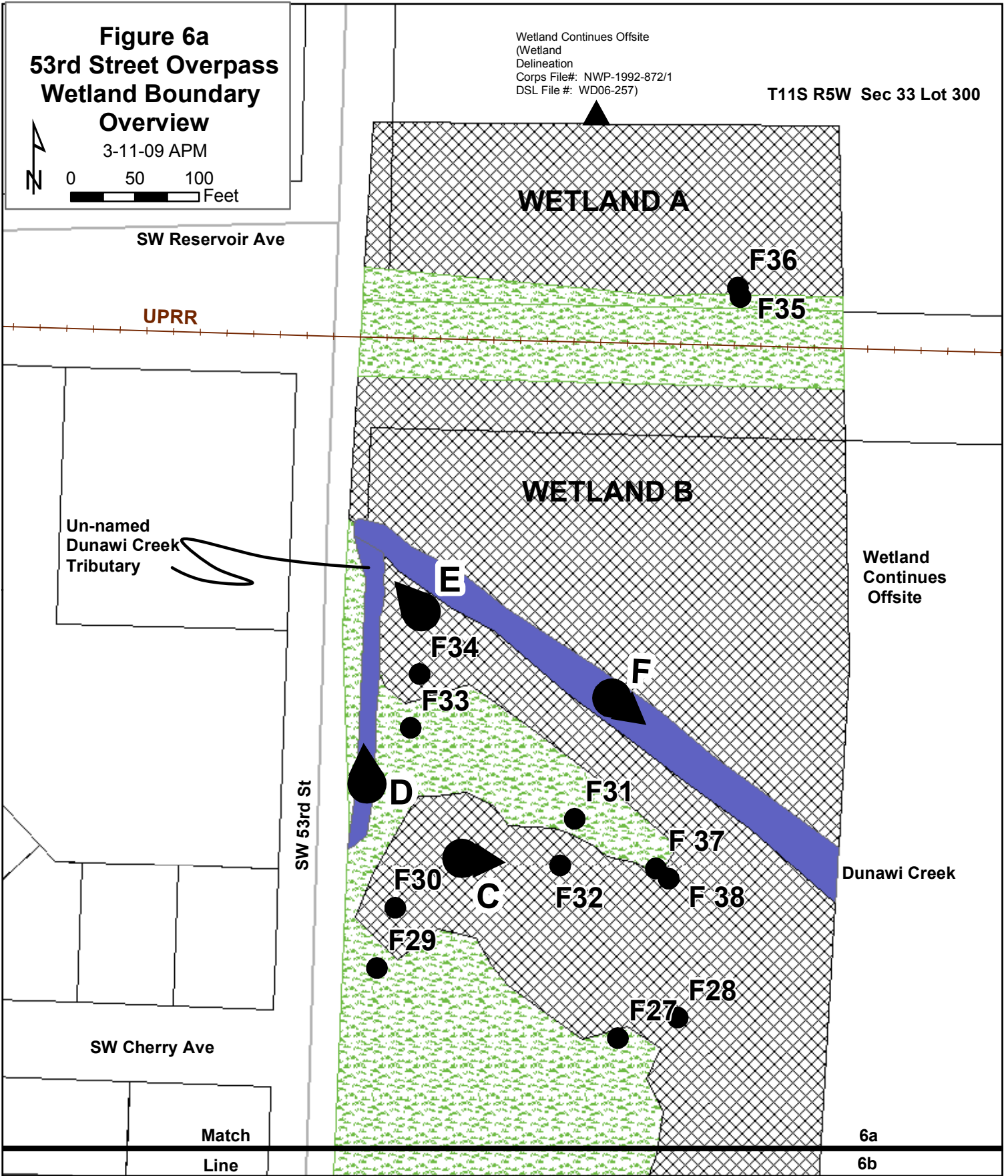

Figure 6a
53rd Street Overpass
Wetland Boundary
Overview

3-11-09 APM
 0 50 100 Feet

Wetland Continues Offsite
 (Wetland
 Delineation
 Corps File#: NWP-1992-872/1
 DSL File #: WD06-257)

T11S R5W Sec 33 Lot 300



KEY

- Data Point
- ⊙ Photo Point
- █ Creek

Study Area 19.75 Acres
 Wetland A 1.07 Acres
 Wetland B 9.02 Acres
 Upland

Dunawi Creek 0.30 Acres
 Un-Named Dunawi
 Creek Tributary 0.08 Acres
 Potential Wetland

Survey completed by Benton County Public Works Survey Division using Leica total stations with Trimble Onboard Software.
 Data points and wetlands boundaries are sub-centimeter accuracy.
 Maps are compiled in Oregon State Plain North 83 Harn Projection.